

RevNo	Revision note	Date	Signature	Checked
V1.0	Sketch only	06/03/2026		

RoHS Compliant.

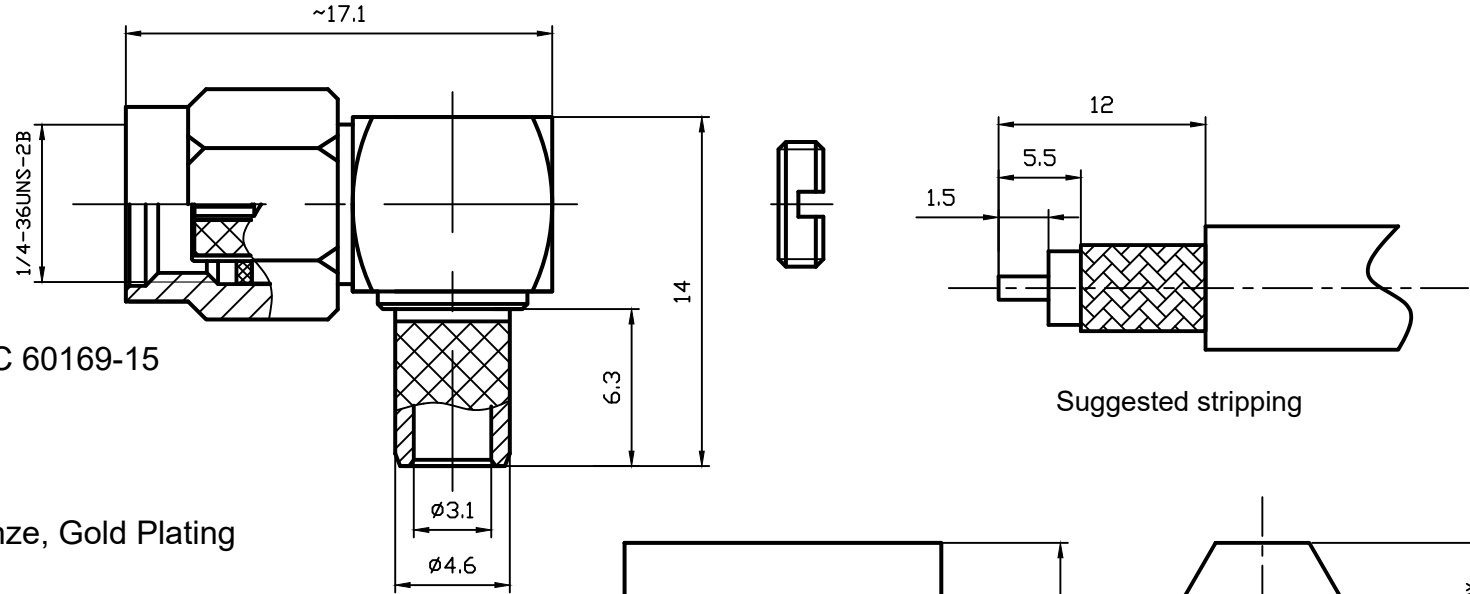

**Interface Per:** MIL-STD-348, IEC 60169-15  
**Cable Type:** RG58/RG223

**Material & Finishing:**

1. Center conductor: Phosphor bronze, Gold Plating
2. Insulators: PTFE
3. Body : Brass, Gold Plating
4. Crimping Ferrule: Soft Copper, Gold Plating

**Electrical Data:**

1. Impedance: 50 Ohms
2. Frequency: 0~6GHz
3. VSWR:  $\leq 1.15$  @ 900MHz,  
 $\leq 1.2$  @ 1800MHz,  
 $\leq 1.3$  @ 3000MHz,  
 $\leq 1.4$  @ 6000MHz,
4. Insertion loss:  $\leq 0.05$ dB @ 900MHz,  
 $\leq 0.05$ dB @ 1800MHz,  
 $\leq 0.05$ dB @ 3000MHz,  
 $\leq 0.05$ dB @ 6000MHz,
5. Dielectric Withstanding voltage: 750V Min
6. Voltage Rating : 350V Max

**Package :** 1 PC per bag  
**Laser Mark:** LenoRF

Suggested stripping

Recommended stamping  
hexagonal die size (cannula)

Label Content:

LenoRF  
Part No: 3.01.433  
Part Name: RP-SMA RA PLUG FO RG58/RG223 CABLE  
QTY: 1 PC  
Date: WW/YY (Week/year)

Unless otherwise specified, tolerances as below: .x $\pm 0.15$ .xx $\pm 0.1$ .xxx $\pm 0.05$ Angle: $\pm 2^\circ$	Material:	See Notes	Weight	g	
	Finish:	See Notes	Scale	8:1	
	Unit	mm	Page	01	
	REV.	V1.0	p/n	01	
Drawn	DATA:	Projection		Cust P/N.	DWG NO. <b>3.01.433</b>
Checked	DATA:	Title: RP-SMA RA PLUG FOR RG58_RG223 CABLE			
Approved	DATA:				